

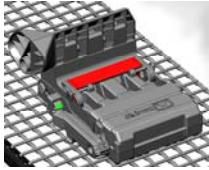







# Holden America Chock Systems Product List

	<u>PART NUMBER</u>	<u>DESCRIPTION</u>
<b>GRIP-LOCK™ CHOCKS</b>		
	GLC-7040	Right Hand Grip-Lock™ Chock (New)
	GLC-7040R	Right Hand Grip-Lock™ Chock (Reconditioned)
	GLC-7041	Left Hand Grip-Lock™ Chock (New)
	GLC-7041R	Left Hand Grip-Lock™ Chock (Reconditioned)
<b>GRATE-LOCK® CHOCKS</b>		
	GLC-7026	Right Hand Grate-Lock® Chock (New)
	GLC-7026R	Right Hand Grate-Lock® Chock (Reconditioned)
	GLC-7027	Left Hand Grate-Lock® Chock (New)
	GLC-7027R	Left Hand Grate-Lock® Chock (Reconditioned)
<b>SUPPLEMENTARY CHOCK</b>		
	GLC-3200	Block-Chock
<b>STORAGE HOOK</b>		
	GLC-3210	Block-Chock Hook (Standard)
<b>HANDLE-LOCK LATCHES</b>		
	GLC-3084	Right Hand Handle-Lock Latch
	GLC-3085	Left Hand Handle-Lock Latch
<b>STORAGE PANS</b>		
	GLC-7034	Right Hand Storage Pan
	GLC-7035	Left Hand Storage Pan



**PART NUMBER**                      **DESCRIPTION**

**FASTENERS**



**GLC-5013**                      **Storage Pan Fastener Kit (Standard)**  
 Kit includes: 1 x GLC-2006 (5/8" x 0.725" Well-Nut);  
 1 x GLC-2007 (5/16" x 3/4" Bolt);  
 1 x GLC-2008 (5/16" Washer)

**GLC-5027**                      **Storage Pan Fastener Kit (Art. Bi-Level)**  
 Kit includes: 1 x GLC-2009 (3/4" x 1-1/16" Well-Nut);  
 1 x GLC-2010 (3/8" x 1-1/4" Bolt);  
 1 x GLC-2011 (3/8" Washer)

**GLC-5034**                      **Storage Pan Fastener Kit (Long)**  
 Kit includes: 1 x GLC-2012 (5/8" x 1.100" Well-Nut);  
 1 x GLC-2013 (5/16" x 1-1/4" Bolt);  
 1 x GLC-2008 (5/16" Washer)

*Note: Kit parts may be purchased separately. Please contact us for more information*



**GLC-2040**                      **Hinge Deck Rivet**

**HINGING AND GRATING KITS**



**GLC-5040**                      **Hinge Kit**  
 Kit includes: 4 x GLC-6001 (Hinge Base);  
 4 x GLC-6002 (Hinge Keeper);  
 1 x GLC-6003 (Hinge End Keeper)

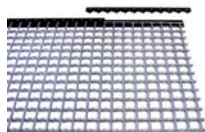

**GLC-7102**                      **Grating Panel and Hinge Kit (Assembled)**  
 Kit includes: 1 x GLC-6000 (Standard Grating Panel);  
 4 x GLC-6001 (Hinge Base);  
 4 x GLC-6002 (Hinge Keeper);  
 1 x GLC-6003 (Hinge End Keeper)

*Note: Approximately 8 deck rivets are required to fasten 1 kit to railcar deck and 2 deck rivets are required per End Keeper piece.*

**INSTRUCTIONAL PLACARDS**

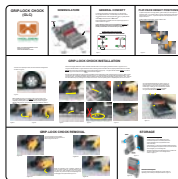

**GLC-5037**                      **48 Grate-Lock® / 48 Block-Chock Configuration – English**

**GLC-5058**                      **96 Grip-Lock™ Chock Configuration – English**

**GLC-5082**                      **48 Grip-Lock™ Chock Configuration - English**



<u>PART NUMBER</u>	<u>DESCRIPTION</u>
--------------------	--------------------

GRATING PANEL THEFT PREVENTION KITS	
-------------------------------------	--



GLC-5084	Grate-Guard™ Kit (for deck sheet thickness 0.250" – 0.375") Kit includes: 1 x GLC-3296 (Grate Guard™ Block); 1 x GLC-2042 (BOM Rivet)
----------	---



GLC-5085	Grate-Guard™ Kit (for deck sheet thickness 0.075" – 0.200") Kit includes: 1 x GLC-3296 (Grate-Guard™ Block); 1 x GLC-2042 (BOM Rivet); 1 x GLC-2043 (Grate-Guard™ Spacer)
----------	--